

# IMPACT UV

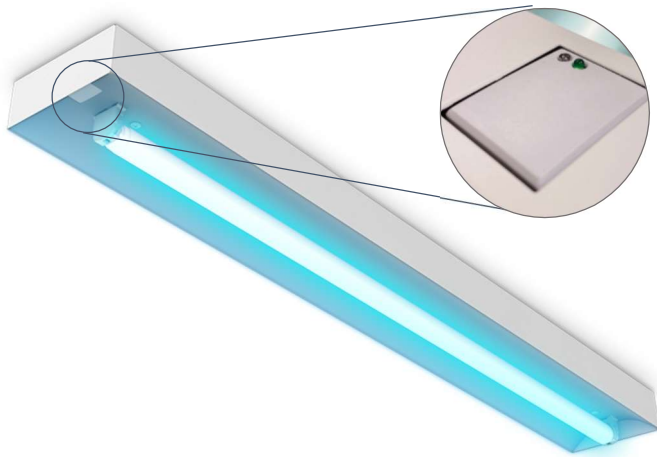

**\*\*Optional**

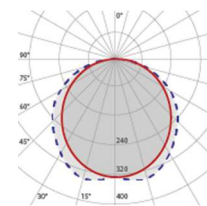
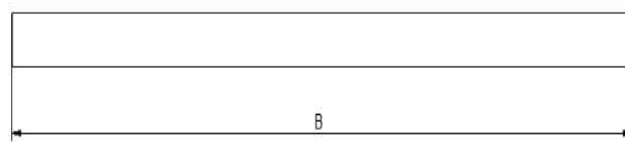
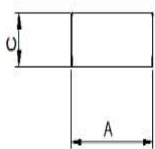
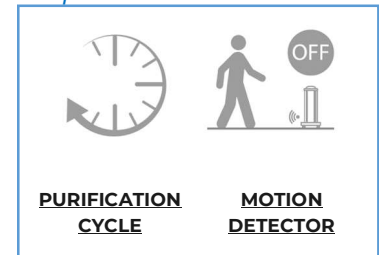

**RSS**  
Symmetrical  
recuperator in satin  
aluminium

Type of installation	Ceiling		
Body	Sheet-steel body powder coated by means of opaque white(RAL 9010) polyester powders, UV resistant. Installation through ABS spacers which are supplied with the luminaire.		
Wiring	CEL version with electronic ballast EEI=A2, 220-240V 50-60Hz, heat ignition.		
** Optional	Motion detector with timer		
Luminous source	FL T26 linear UV-C lamp with wavelength 254 nm, lamp coupling G13.		
Power	1x30W	1x36W	1x55W
UV-C rendering (253,7 nm)	12W	15W	18W
UV-C Irradiation	0,12W/m <sup>2</sup> at 2,5 m	0,15W/m <sup>2</sup> at 2,5 m	0,18W/m <sup>2</sup> at 2,5 m
Dimensions	A:130mm B: 982mm C: 55mm	A:130mm B: 982mm C: 55mm	A:130mm B: 982mm C: 55mm
Duration of UV-C sources	8000 hours		
Operating temperature	-10°C ~ +35°C		
Suitable for environments of	12 m <sup>2</sup>	15 m <sup>2</sup>	18 m <sup>2</sup>
Irradiation time *	30 minutes		
Appliance compliant with	EN 60598 EN 55015, EN 61000 EN 60529	electrical safety electromagnetic compatibility degree of protection	

\* Necessary to eradicate the most common microorganisms with 99% effectiveness.