

**Description:** LED light fitting suitable for surface or wall installation. It can be used to enlighten common areas, stairs, corridors and restrooms.

**Body:** realized in steel sheet, polished in white (RAL 9003) with thermosetting epoxy powders coatings at 180°C, after having undergone a degreasing, phosphating and washing treatment.

Body completed with ABS head-caps, and it is UV-stabilized.

**Optical group:** transparent **polycarbonate diffuser (CPT)**, UV-stabilized, with optimal mechanical and elastic features. The translucent finish of the diffuser allows a better glare control and a great light uniformity. Snap-in fixing without any tool.

Glow-wire test resistant optics (850°C) according to the CEI EN 60695-2-11 directives.

Protection degree: **IP40**.

**Wiring:** feeding at 220-240V 0/50/60 Hz with rigid cable, section 0,50 mm<sup>2</sup> and PVC-HT sheathing resistant at 90°C according to CEI 20-20 directives. Terminal board with maximum wire section allowed of 2,5 mm<sup>2</sup>. Insulation class I. It is suitable to be installed on normally flammable surfaces.

- **LED** version with ON/OFF electronic driver, fixed output, included.
- **LED DALI** version with digital dimmable DALI driver, included.
- **LED-E** and **LED-E (DALI)** emergency versions, with emergency kit. In case of black-out or no electrical feeding, the LED module connected to the emergency group keeps on working. 60 minutes autonomy, batteries included.

**Luminous source:**

High efficiency LED modules, CRI>80 (CRI>90 available on request), colour temperature **3000K** and **4000K** (LED diodes selected 3 MacAdam ellipses to grant a uniform chromaticity, 5000K, 6500K CRI>80 available upon request).

Duration of LEDs in normal conditions: over **50.000** hours at **L90/B10** at a RT of 25°C.

Suggested max. operating temperature: 35°C, 25°C with emergency kit.

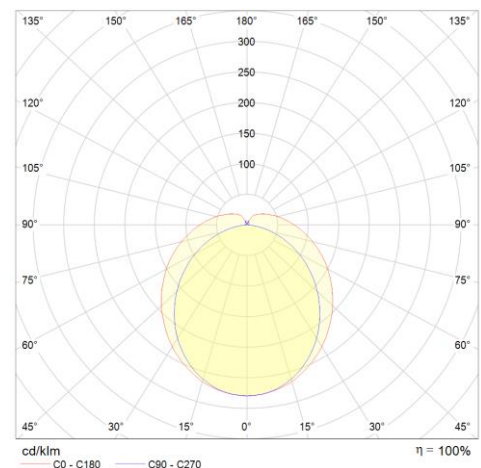
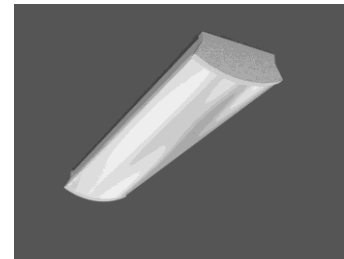

**Regulations:** luminaire in conformity with:

- |                |                  |                            |
|----------------|------------------|----------------------------|
| • EN 61547     | • IEC/TR 62471-2 | • EN 60598-2-13            |
| • EN 55015     | • EN 60061-1     | • EN 62471 (risk class: 0) |
| • EN 61000-3-2 | • EN 62031       | • EN 62560                 |
| • EN 61000-3-3 | • EN 62493       | • EN 60968                 |
| • EN 60529     | • EN 60598-1     |                            |

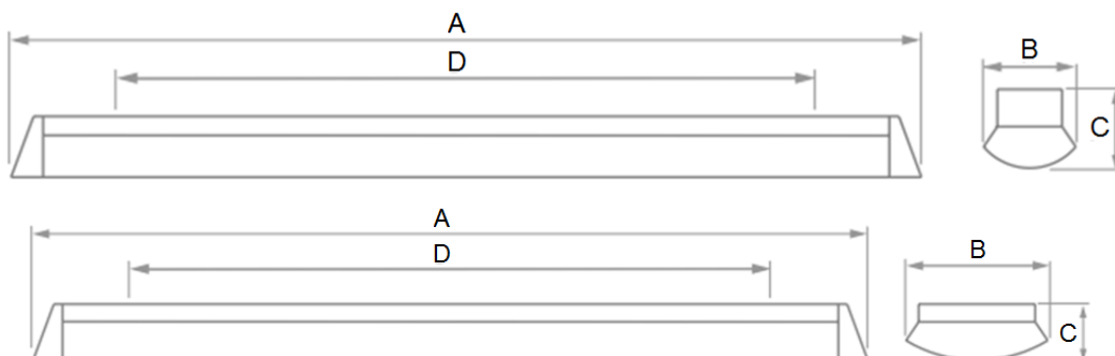



Power [W]	Colour temperature (K)	CRI	Net lumen output [lumen]*	Efficiency [lm/W]	Energy class	Dimensional table [mm]			
						A	B	C	D
10	3000K	>80	985	99	A++	610	91	82	500
10	4000K	>80	1040	104	A++	610	91	82	500
12	3000K	>80	1184	99	A++	610	91	82	500
12	4000K	>80	1250	104	A++	610	91	82	500
18	3000K	>80	1809	101	A++	1170	91	82	1000
18	4000K	>80	1910	106	A++	1170	91	82	1000
22	3000K	>80	2235	102	A++	1170	91	82	1000
22	4000K	>80	2360	107	A++	1170	91	82	1000
22	3000K	>80	2188	99	A++	1450	91	82	1000
22	4000K	>80	2310	105	A++	1450	91	82	1000
27	3000K	>80	2756	102	A++	1450	91	82	1000
27	4000K	>80	2910	108	A++	1450	91	82	1000
18	3000K	>80	1790	99	A++	610	146	58	500
18	4000K	>80	1890	105	A++	610	146	58	500
22	3000K	>80	2225	101	A++	610	146	58	500
22	4000K	>80	2350	107	A++	610	146	58	500
35	3000K	>80	3570	102	A++	1170	146	58	1000
35	4000K	>80	3770	108	A++	1170	146	58	1000
42	3000K	>80	4394	105	A++	1170	146	58	1000
42	4000K	>80	4640	110	A++	1170	146	58	1000
44	3000K	>80	4498	102	A++	1450	146	58	1000
44	4000K	>80	4750	108	A++	1450	146	58	1000
53	3000K	>80	5493	104	A++	1450	146	58	1000
53	4000K	>80	5800	109	A++	1450	146	58	1000

Codes / Wiring	
LED	LED DALI
359000132	359000133
359000052	359000093
359000134	359000135
359000110	359000115
359000135	359000136
359000094	359000095
359000111	359000137
359000015	359000096
359000165	359000142
359000098	359000099
359000112	359000145
359000016	359000097
359000148	359000149
359000101	359000102
359000150	359000151
359000017	359000100
359000109	359000152
359000105	359000106
359000155	359000156
359000072	359000103
359000159	359000113
359000107	359000108
359000162	359000114
359000020	359000104

\*The effective flux could have a tolerance of ±10%.

Power [W]	Colour temperature (K)	CRI	Net lumen output [lumen]*	Efficiency [lm/W]	Energy class	Dimensional table [mm]			
						A	B	C	D
18	3000K	>80	1809	101	A++	1170	91	82	1000
18	4000K	>80	1910	106	A++	1170	91	82	1000
22	3000K	>80	2235	102	A++	1170	91	82	1000
22	4000K	>80	2360	107	A++	1170	91	82	1000
22	3000K	>80	2188	99	A++	1450	91	82	1000
22	4000K	>80	2310	105	A++	1450	91	82	1000
27	3000K	>80	2756	102	A++	1450	91	82	1000
27	4000K	>80	2910	108	A++	1450	91	82	1000
35	3000K	>80	3570	102	A++	1170	146	58	1000
35	4000K	>80	3770	108	A++	1170	146	58	1000
42	3000K	>80	4394	105	A++	1170	146	58	1000
42	4000K	>80	4640	110	A++	1170	146	58	1000
44	3000K	>80	4498	102	A++	1450	146	58	1000
44	4000K	>80	4750	108	A++	1450	146	58	1000
53	3000K	>80	5493	104	A++	1450	146	58	1000
53	4000K	>80	5800	109	A++	1450	146	58	1000

Codes / Wiring	
LED-E	LED-E DALI
359000138	359000139
359000116	359000117
359000140	359000141
359000119	359000118
359000143	359000144
359000120	359000121
359000146	359000147
359000122	359000123
359000153	359000154
359000124	359000125
359000157	359000158
359000131	359000126
359000160	359000161
359000128	359000127
359000163	359000164
359000129	359000130

\*The effective flux could have a tolerance of  $\pm 10\%$ .