



Description: Round recessed LED downlight with direct light.

Body: body in die-cast aluminum, painted white with epoxy powders stabilized to UV rays, thermosetting at 180 ° C, after degreasing, phosphating and washing treatment. The device is supplied complete with brackets for fixing to the false ceiling.

Optical group: internal reflector in metallized polycarbonate, protective glass on the LED source. **50 °** symmetrical opening beam (for model with 80 mm diameter), **55 °** beam (for models with 105, 125, 155 mm diameter), **60 °** beam (for models with 210 mm diameter). Optics with controlled light emission with luminance values <1500 cd / m² for emission angles higher than 65 ° on all planes (UGR <17 for X = 4H, Y = 3H reflection coefficients 70/50/20) and therefore compliant to be installed in environments with the use of video terminals according to the UNI EN 12464-1 standard. Protection degree **IP20**.

Wiring: power supply 220-240V 50 / 60Hz with rigid cable, sect. 0.50 mm² and PVC-HT sheath resistant to 90 ° C according to CEI 20-20 standards. Insulation class II. Suitable for installation on normally flammable surfaces.

- LED version with fixed output electronic driver for independent use, included
 - LED DALI dimmable version, with standard digital dimmable electronic driver DALI for independent use, included.
- On request available:
- Versions with 1/3 hour autonomy emergency kit.

Luminous source: High efficiency LEDs arranged on rigid modules, color rendering CRI> 80 (CRI> 90 available on request), color temperature 3000K or 4000K (LED diode selected 3 MacAdam ellipses in order to guarantee uniform chromaticity), duration> 50000 hours L80 / F10 at Ta = 25 ° C.

Regulations: appliance complies with the following standards:

- | | |
|-----------------|------------------|
| • EN 61547 | • IEC/TR 62471-2 |
| • EN 55015 | • EN 60061-1 |
| • EN 61000-3-2 | • EN 62031 |
| • EN 61000-3-3 | • EN 62493 |
| • EN 61347-1 | • EN 60598-1 |
| • EN 61347-2-13 | • EN 60598-2-1 |
| • EN 60968 | • EN 60598-2-2 |
| • CEI 76-10 | • EN 62471 |
| • EN 60529 | • EN 62560 |



Demonstration image

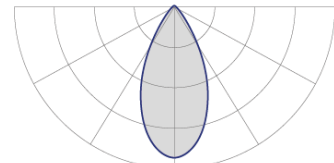

Photometric curve 50°

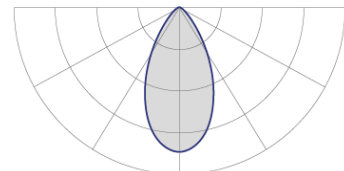

Photometric curve 55°

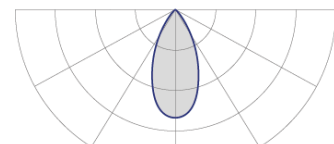

Photometric curve 60°

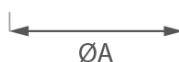
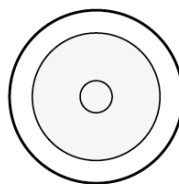
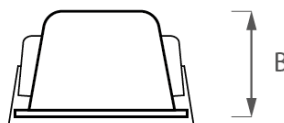



∅ 80						Dimensions [mm]			Codes/Wiring	
Power [W]	Color temperature [K]	CRI	Effective flux [lm] *	Efficiency [lm/W]	Energetic class	∅ A	B	∅ recessed	LED	LED DALI
12	3000	>80	1020	85	A++	80	60	70	575200063	575200064
12	4000	>80	1060	88	A++	80	60	70	575200061	575200062

∅ 105						Dimensions [mm]			Codes/Wiring	
Power [W]	Color temperature [K]	CRI	Effective flux [lm] *	Efficiency [lm/W]	Energetic class	∅ A	B	∅ recessed	LED	LED DALI
12	3000	>80	1275	106	A++	105	80	100	575200001	575200004
12	4000	>80	1335	111	A++	105	80	100	575200002	575200005
17	3000	>80	1765	103	A++	105	80	100	575200003	575200006
17	4000	>80	1846	108	A++	105	80	100	575200007	575200010
21	3000	>80	2070	98	A++	105	80	100	575200008	575200011
21	4000	>80	2175	103	A++	105	80	100	575200009	575200012

∅ 125						Dimensions [mm]			Codes/Wiring	
Power [W]	Color temperature [K]	CRI	Effective flux [lm] *	Efficiency [lm/W]	Energetic class	∅ A	B	∅ recessed	LED	LED DALI
12	3000	>80	1275	106	A++	125	90	115	575200019	575200022
12	4000	>80	1335	111	A++	125	90	115	575200020	575200023
17	3000	>80	1765	103	A++	125	90	115	575200021	575200024
17	4000	>80	1850	108	A++	125	90	115	575200013	575200016
24	3000	>80	2365	98	A++	125	90	115	575200014	575200017
24	4000	>80	2490	103	A++	125	90	115	575200015	575200018

∅ 155						Dimensions [mm]			Codes/Wiring	
Power [W]	Color temperature [K]	CRI	Effective flux [lm] *	Efficiency [lm/W]	Energetic class	∅ A	B	∅ recessed	LED	LED DALI
17	3000	>80	1765	103	A++	155	105	145	575200025	575200028
17	4000	>80	1860	109	A++	155	105	145	575200026	575200029
24	3000	>80	2370	98	A++	155	105	145	575200027	575200030
24	4000	>80	2490	103	A++	155	105	145	575200031	575200034
32	3000	>80	2920	91	A++	155	105	145	575200032	575200035
32	4000	>80	3065	95	A++	155	105	145	575200033	575200036

∅ 210						Dimensions [mm]			Codes/Wiring	
Power [W]	Color temperature [K]	CRI	Effective flux [lm] *	Efficiency [lm/W]	Energetic class	∅ A	B	∅ recessed	LED	LED DALI
17	3000	>80	1950	114	A++	210	114	200	575200037	575200052
17	4000	>80	2035	119	A++	210	114	200	575200050	575200053
25	3000	>80	2660	106	A++	210	114	200	575200051	575200054
25	4000	>80	2770	110	A++	210	114	200	575200055	575200058
39	3000	>80	3800	97	A++	210	114	200	575200056	575200059
39	4000	>80	3960	101	A++	210	114	200	575200057	575200060

* Actual flow may have a tolerance of ± 10%.